



Home & Land Packages



THE SEACOMBE

**LOT 6 'ENCOUNTER LAKES'
VICTOR HARBOR**

This package includes:

- 388m2 of land in the fantastic setting of Encounter Lakes
- Rossdale Homes Seacombe design built to Sovereign Specifications with 4 Bedrooms and 2 living areas
- Double garage with upgraded panel lift doors and internal access
- Front elevation as per current display home including feature 3m ceilings to Master Bedroom and Ensuite
- Talking about ensuite, WOW! this ensuite is awesome
- Mirrored Built in robes to Master bedroom and Built in robes to bed 2 and 3, Laundry and Linen cupboards included
- Reverse Cycle Ducted A/C for all year round comfort
- Tiling to front porch with floating timber floors to all living area and quality carpets to all bedrooms
- All services are taken care of including the in ground gas supply
- Storm-water and rainwater tank requirements are included as well
- Perimeter paths and driveway are all done
- More options than I can fit hear, call me today to find out more.

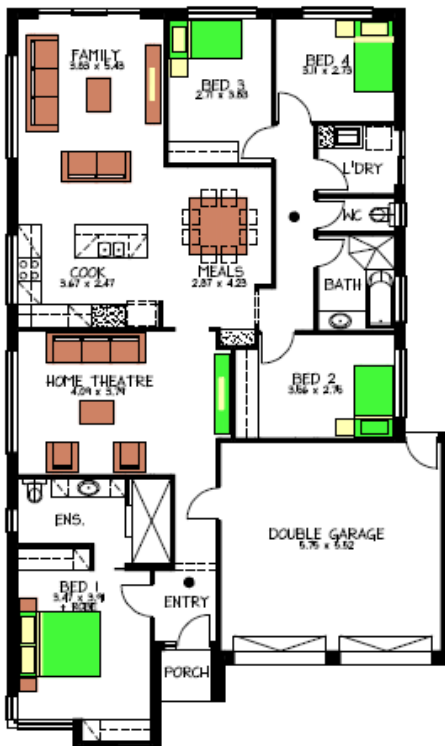

Disclaimer: All care has been taken in the preparation of this material. No responsibility is taken for any errors or omissions. Details are subject to change without notification. Images for illustration purposes only. E&EO.

PACKAGE FROM: \$433,000

HOME: \$243,000 LAND: \$190,000

**FOR THIS OFFER CALL
BRAD: 0421 940 398**

P: 08 8433 2000 www.rossdalehomes.com.au

**ROSSDALE
HOMES** *Because trust is a must.*